



The State of Texas } Know all men by these
 County of Walker } Presents that I John
 Wright of the State of Kentucky by my agent and attorney in fact
 R. B. Martin for and in consideration of the sum of Thirty Dollars and fifty cents
 cash to me in hand paid by said R. B. Martin
 receipt of which is hereby fully acknowledged
 I said Martin as agent as aforesaid with
 full Power vested in me by Power attorney
 have this day granted, Bargained sold
 aliened and Conveyed and set over in bone
 fide sale unto him said Elliott his heirs
 or assigns the following described tract of
 land - To Wit = Beginning 140 m N from
 E. M. Jarvis N. E. Corner. A pine 17 in dia brs S 75 E 8 m
 dia brs N 25 W 7 m a pine 13 in dia brs S 75 E 8 m
 Thence S. 800 m a corner from a pine 13 in dia
 brs S 44 W 3 m a pine 7 in dia brs N 10 W 10 m = Thence
 E 500 m a pine 13 in dia brs S 80 W 14 m a pine
 10 in dia brs N 80 W 12 m = Thence N. 800 m a
 corner on Roberts N. B. line a pine 12 in dia brs
 N 16 W 9 m a pine 12 in dia brs S 15 W 4 m = Thence
 with Roberts N. B. line 500 m to the place
 of beginning. Containing Seventy One (71) acres
 of land being a part of the Jarvis and
 E. M. Jarvis 640 acre surveys being situated
 in Trinity County and State aforesaid and
 the said J. J. Elliott his heirs or assigns
 to have and to hold the above described
 tract of land together with all and singular
 the rights improvements and appertinances
 thereto belonging or in any wise apper-
 taining to the same, and I said John Wright

State of Texas } I hereby certify that the above
 County of Trinity } deed is duly Recorded in Book
 of deeds } No. on pages 286 + 287 Record

Given under my hand
 and Official Seal this
 April 22nd 1878

J. J. Evans
 Co. Clerk

Jarvis	24 7/16	Probert
	46 9/16	

This Deed covers 24 7/16 acres of the Jarvis survey
 and 46 9/16 of the Probert survey - making total amt of 71 acres

O. C. Hollands.
 Co. Surveyor T. C. T.

Scale 1000' = 1 inch.

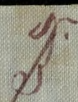

N. 30 E. 5881

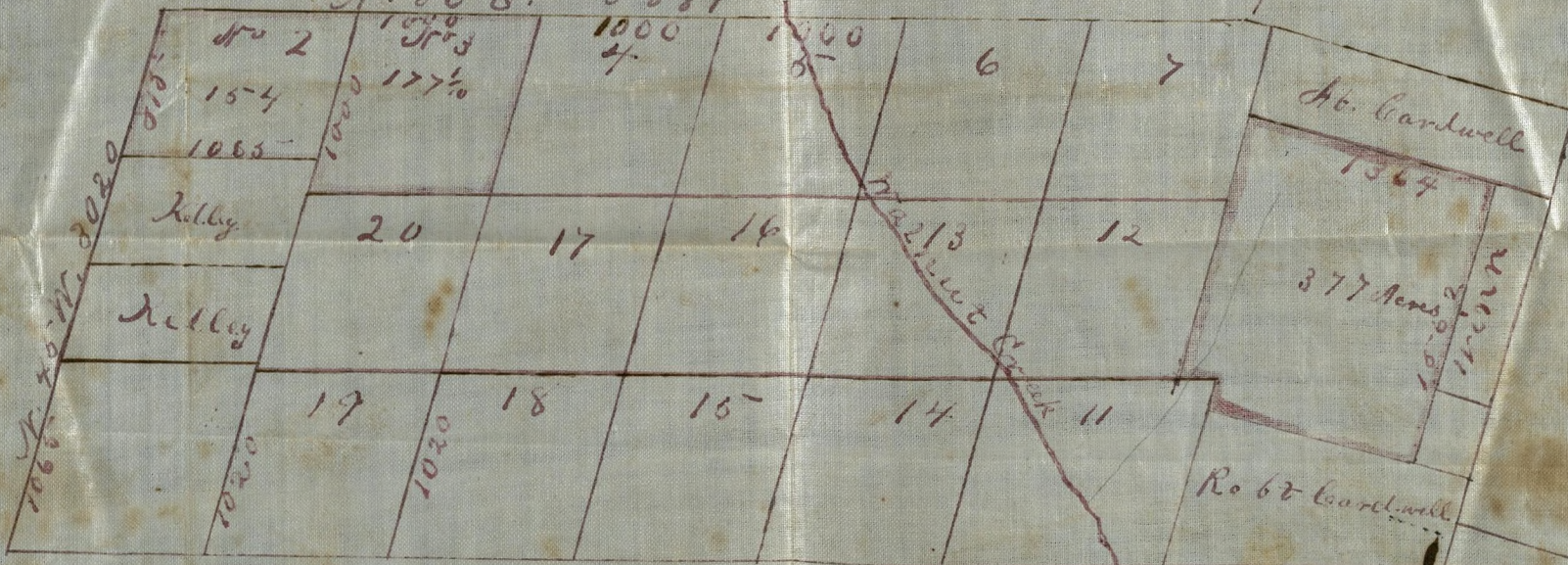

N. 40 W. 8020
1065

At. Cardwell
1364

377 Acres

Robt Cardwell

8760



134
177
311

377
331
708